

# DD6

## Ultra-compact Differential Dispersion™ System

touring & theatre

### features

- ▶ Ultra-compact, ultra-versatile, passive 2-way system
- ▶ Differential Dispersion™, rotatable horn, configurable without tools
- ▶ Portrait or landscape surface mount or stage monitor use
- ▶ High-linearity 6.5" (165mm) bass / mid driver
- ▶ 0.5" (12.5mm) exit HF driver
- ▶ Magnetically retained, quick-release perforated steel grille
- ▶ Comprehensive mounting and flying options

### applications

- ▶ Theatre & live sound reinforcement
- ▶ Corporate audio-visual events
- ▶ Houses of worship
- ▶ Front fill and under-balcony

The DD6's Differential Dispersion technology provides an advanced solution to the requirements of even coverage over wide angles and medium throw distances.

Designed using Martin Audio's in-house BEM (Boundary Element Method) tools, the short throw horizontal dispersion of the horn is 120°, narrowing to 90° as throw increases. Vertically, the horn covers 60°, with greater output above the horizontal centre plane.

The combination of narrower horizontal dispersion and greater output above the horn's horizontal centre plane creates progressively more HF output as the throw distance increases. The resultant dispersion pattern is ideally suited to covering audiences located on flat or gradually sloping surfaces.

The comprehensive mounting options offer an incredible degree of flexibility for any application. M8 inserts can be used with eyebolts and there are three dedicated brackets available; a multipurpose vertical tilt bracket which can be attached to the top, bottom or side of the DD6 and can be used with a top hat fitting or scaffold clamp, a yoke for fitting to walls or ceilings in any orientation, and a wall bracket with vertical and horizontal adjustment for invisible fitting to a wall.



### technical specifications

TYPE	Differential Dispersion™ ultra-compact, multi-angled, two-way passive
FREQUENCY RESPONSE	70Hz-20kHz ±3dB -10dB @ 55Hz
DRIVERS	6.5" (165mm)/1.75" (44mm) voice coil neodymium magnet LF driver 0.5" (12.5mm) exit neodymium magnet HF compression driver
RATED POWER (a)	150W AES, 600W peak
RECOMMENDED AMPLIFIER	400W-1200W into 4 ohms
SENSITIVITY (b)	91 dB
MAXIMUM SPL (c)	113dB continuous, 119dB peak
NOMINAL IMPEDANCE	16 ohms
DISPERSION (-6dB)	90°-120° horizontal, 60° vertical
CROSSOVER	3.7kHz passive
ENCLOSURE	7 litre, multi-laminate birch ply
FINISH	Textured black polyurethane coating
PROTECTIVE GRILLE	Black perforated steel
CONNECTORS	4 x Neutrik® NL4, connected in parallel
INPUT CONNECTIONS	1+, 1- or 2+, 2- selected via rear-mounted switch
FITTINGS	8 x M8, 4 x M6 threaded inserts, Integrated Pocket Handle
DIMENSIONS	(W) 190mm x (H) 359mm x (D) 207mm (W) 7.5ins x (H) 14.1ins x (D) 8.1ins
WEIGHT	5.9Kg (13lbs)

#### Notes

- AES Standard ANSI S4.26-1984
- Measured in open (4π) space at 2 metres with 1 watt input, using band limited pink noise, then referred to 1 metre
- Measured in open (4π) space at 2 metres using band limited pink noise, then

Century Point, Halifax Road, Cressex Business Park,  
High Wycombe, Buckinghamshire HP12 3SL, England.  
Telephone: +44 (0)1494 535312 Facsimile: +44 (0)1494 438669  
E-mail: info@martin-audio.com  
All information is Copyright © 2010 Martin Audio Ltd.



### overall dimensions

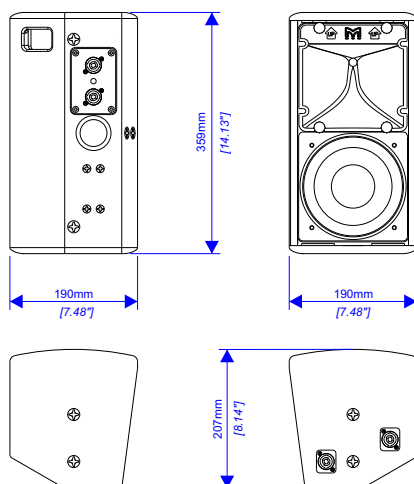

DD6

[www.martin-audio.com](http://www.martin-audio.com)